

WELCOME

TO



AMTRANET GROUP

Greetings from CEO & Chairman



DEAR CUSTOMERS,

THE SUCCESS STORY OF AMTRANET GROUP GOES BACK IN THE YEAR 1995, WHEN WE STARTED THE JOURNEY WITH ONE SINGLE GARMENTS UNIT.

AS A RESULT OF OUR DEDICATION AND INCREASED CUSTOMER SATISFACTION BY THE END OF THE YEAR 2000 WE EXPANDED GRADUALLY WITH 3 (THREE) MORE GARMENTS MANUFACTURING UNITS. WITHIN THIS PERIOD WE ALSO SET-UP ONE ACCESSORY+ CARTON MANUFACTURING UNIT TO STRENGTHEN OUR BACKWARD LINKAGE SUPPORT.

TO MEET OUR CUSTOMERS CONTINUOUS DEMAND AND TO ENTER INTO THE VALUE ADDED MARKET BY THE YEAR 2006 WE EXPANDED ONCE AGAIN AND ESTABLISHED GARMENT EXPORT VILLAGE LTD (GEVL). GEVL IS A TEN STORIED BUILDING WITH 8 DIFFERENT MANUFACTURING UNITS - OF THEM WRINKLE FREE TROUSER UNIT, DRESS SHIRT AND TROUSER UNITS, MULTI-GAUGE JACQUARD UNIT, IN-HOUSE WASHING, PRINTING, EMBROIDERY UNITS AND OTHER AUXILIARY UNITS.

BESIDES THE LARGE MANUFACTURING FACILITIES AND LONG STANDING EXPERIENCE, OUR STRENGTH ALSO RELY ON OUR HIGH SKILLED HUMAN CAPITAL – PROFESSIONAL OPERATING TEAM, QUALITY CONTROL TEAM, EXPERIENCE AND YOUNG ENERGETIC MERCHANDISING TEAM MEMBERS. MOREOVER WE INSTALLED WORLD-CLASS BRAND MACHINERIES IN OUR FACTORIES.

AT THE END I WOULD ALSO LIKE TO THANK ALL OUR VALUED CUSTOMERS, SUPPLIERS, AND PARTNERS, BECAUSE THEIR SUPPORT HELPED US TO GO FORWARD.

SINCERELY YOURS,

A.K.M. BADIUL ALAM
CEO & CHAIRMAN
AMTRANET GROUP
MAA TOWER
K B M ROAD, TONGI I/A
TONGI, GAZIPUR, BANGLADESH.
TEL: 880-2-9814200 (Hunting)
FAX: 880-2-9813181
E-MAIL : info@amtranet.com
WEBPAGE : <http://www.amtranet.com>

CORPORATE OFFICE AND FACTORY COMPLEX

GARMENTS EXPORT VILLAGE

MAA Tower
K.B.M Road,
Tongi Industrial Area
Tongi, Gazipur, Bangladesh
TELEPHONE: 9814200 (Hunting)
FAX- 9813181
E-mail – info@amtranet.com



SHIRT MINE LTD. **POWER VANTAGE WEAR LTD.** **GREYSTONE SWEATER LTD.**

Kafrul Tower
234/8 Kachukhate,
Dhaka Cantonment
Dhaka, Bangladesh
TEL: 9891949,9891952
FAX :9872123
E-mail: info@amtranet.com



AMTRANET HONGKONG

ROOM-1317, BEVERLY COMMERCIAL CENTRE
87 CHATHAM ROAD SOUTH, TSIM SHA TSUI
KOWLOON, HONG KONG
TEL : (852) 21997648 Fax : (852) 31703605
E-MAIL : global5@netvigator.com

BANK

EXPORT IMPORT BANK OF B'DESH
Gulshan Branch
75, GULSHAN AVENUE
GULSHAN , DHAKA
TELEX : 632125 EXMGL B
SWIFT: EXBK BD DHA007
TEL: 9862262, 9886296, 8818703

*Group Corporate
Office*



Reception



Show room



← Office area

Conference room



FACTORY PROFILE

GARMENTS EXPORT VILLAGE LTD.

UNIT-1 : DRESS / FORMAL TROUSER UNIT

UNIT-2 : DRESS / WRINKLE FREE SHIRT UNIT

UNIT-3 : PLAIN / JACQUARD SWEATER UNIT

UNIT-4 : CHINO/ WRINKLE FREE PANT UNIT

UNIT-5 : SUIT + BLAZER UNIT (FUTURE PLAN)

UNIT-6 : EMBROIDERY UNIT

UNIT-7 : PRINTING UNIT

UNIT-8 : WASHING UNIT

SHIRTS MINE LTD

DRESS/FORMAL SHIRTS UNIT

POWER VANTAGE WEAR LTD

FORMAL/CASUAL TROUSER UNIT

GREYSTONE SWEATER LTD

SWEATER / PULLOVERS UNIT.

ORBITAL ACCESSORIES LTD

GARMENTS ACCESSORIES AND CARTONS UNIT.

GEVL – Floor Planning

DINING, PRAYER, RECREATION ETC.

SUIT SEWING AND FINISHING FLOOR.

CORPORATE OFFICE.

CHINO/WRINKLE FREE TROUSER SEWING FLOOR

DRESS SHIRT SEWING AND FINISHING FLOOR.

SWEATER FLOOR.

DRESS PANT , FORMAL TROUSER SEWING FLOOR

WASHING PLANT / DRESS TROUSER AND WRINKLE FREE TROUSER FINISHING FLOOR.

EXPORT GODOWN / JACQUARD UNIT / PRINTING SECTION

FACTORY ADMINISTRATION DEPARTMENT / DOCTOR'S ROOM / CHILDREN CARE AND WELFARE CENTER / IMPORT GODOWN/ 1000 KV ELECTRIC SUBSYSTEM/ 800KW GAS GENERATOR
 30 HP VACUAM PUMP/ 70 HP AIR COMPRESSOR/ FIRE FIGHTING SYSTEM/ WATER DOSING PUMP
 BOILER ROOM/ 250 CBM3 EFFLUENT TREATMENT PLANT/ 250 CBM3 WATER TREATMENT PLANT/
 CONTAINER LOADING & UNLOADING SYSTEMS / MAINTENANCE DEPARTMENT
 EMBROIDERY SECTION

SECTION ON : C-C

SECTION ON - E-E

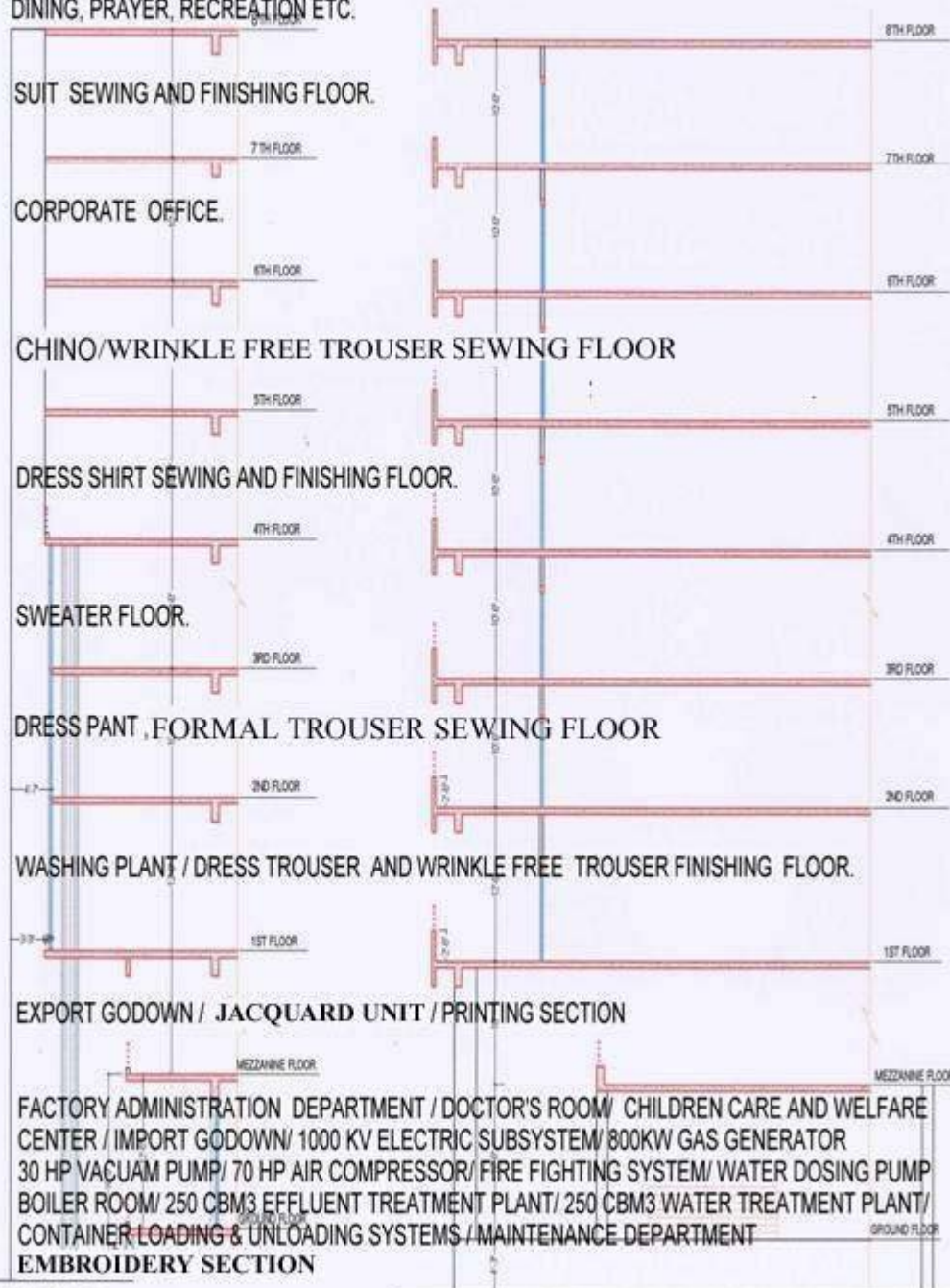

GEVL - Embroidery Unit

(GROUND FLOOR)



MACHINERIES INFORMATION

QNTY

- >BARUDAN Computerised Embroidery Machine 20 Heads
- >BARUDAN Computerised Embroidery Machine 4 Heads

2 Set
1 Set



**Capacity : 10,000 pcs per day with
5000 stitches in 9 colors**

GEVL - Printing Unit (MEZZANINE FLOOR)



MACHINERIES INFORMATION

- >> *Printing Table auto run Infrared Dryer : 60' Length*
- >> *Flock Printing Machine*
- >> *Heat Transfer Print Machine*
- >> *Conveyor Dryer*
- >> *Screen Tension Machine*
- >> *Expose Machine With Vacuum*

QNTY

- 02 Unit*
- 01 Set*
- 02 Sets*
- 01 Set*
- 01 Set*
- 01 Set*



Capacity: 10,000 pcs day in 7 colors

GEVL Washing Unit (FIRST FLOOR)



MACHINERIES INFORMATION:

Industrial Washing Machine

Industrial Centrifugal separator (Hydroextractor)

Industrial Laundry Dryer

QNTY

9 Sets

3 Sets

10 Sets



***Capacity : 7000 – 10,000 pcs/DAY
(Regular + Chemical Wash)***

GEVL Jacquard Knitting Unit
(MEZZANINE FLOOR)



STOLL Multiguage(6 to 12 GG) machine – German Origin

32 Units



Capacity : 70,000 pcs / Month

GEVL Wrinkle Free Post Cured Unit (FIRST FLOOR)



<u>MACHINERIES INFORMATION :</u>	<u>QNTY</u>
Wrinkle free curing oven conveyer(USA)	1 Set
Wrinkle free curing batch oven	2 Sets
Automatic toper presser	24 Sets
Automatic legger presser	12 Sets
Pressing table with Buckle	24 Sets



Production Capacity : 100,000 pcs / Month

GEVL Dress and Formal Trouser Unit (SECOND FLOOR)



MACHINERIES INFORMATION

QNTY

Fabrics Shrinkage machine - Hasima	1 Set
Fabrics inspection and winding machine - Weishi- China	1 Set
Automatic spreading machine - Estman	1 Set
Straight Knife cutting machine - Estman	4 Sets
Band Knife Cutting machine - Estman	2 Sets
Straight Liner Fusing machine - Hasima	2 Sets
Inner waist band making set - Uzu-Thailand	2 Sets
Blind stitch machine for waistband/hem - Maier- Germany	3 Sets
Blind stitch spot tacking machine - Maier- Germany	3 Sets
Nose/Belt Extension Making Machine - Durkopp-Germany	3 Sets
Serging Machine - Durkopp-Germany	5 Sets
Waistband joining machine - Durkopp-Germany	2 Sets
Continuous belt loop Making machine - Maier-Germnay	2 Sets
Automatic Darts and pleats sewing machine - Durkopp-Germany	2 Sets
Pocket welting machine - Durkopp-Germany.	3 Sets
Pocket pressing - Durkopp-Germany.	3 Sets
Eye let hole machine - Durkopp-Germany.	5 Sets
Bar Tack Machine - Juki-Japan	11 Sets
Needle feed lock stitch machine computerized - Durkopp-	6 Sets
Double Needle chain stitch - Durkopp-Germany	6 Sets
Single needle lock stitch machine -Juki-Japan	24 Sets
Single needle feed lock stitch machine computerized -Juki-Japan	111 Sets
Double needle, Needle feed lock stitch machine -Juki-Japan	3 Sets
Overlook machine -Juki-Japan	12 Sets
Double needle chain stitch machine -Juki-Japan	6 Sets
Tandem machine -Juki-Japan	6 Sets
Vertical Trimmer -Juki-Japan	9 Sets
Button stitch machine	3 Sets
Kansai specialized - Uniun	3 Sets

PRODUCTION CAPACITY: 80,000 PCS/MONTH

GEVL Sweater Unit (Finishing) (THIRD FLOOR)



MACHINERIES INFORMATION

Auto placket machine
Dial Linking machine - 8 Gauge
Dial Linking machine -12 Gauge
Dial Linking machine -14 Gauge
Light cone check
Vacuum Iron table

QNTY

8 Sets
100 Sets
100 Sets
210 Sets
8 Sets
30 Sets



Production Capacity : 150,000 Pcs/Month

GEVL Dress and Pre-Curing Shirt Unit (FOURTH FLOOR)



MACHINERIES INFORMATION

QNTY

Fabrics Shrinkage machine	- Hasima	
Fabrics inspection and winding machine	- Weishi	1 Set
Automatic spreading machine	- Estman	1 Set
Straight Knife cutting machine	- Estman	4 Sets
Band Knife Cutting machine	- Estman	2 Sets
Fusing machine	- Hasima	1 Sets
Rotary Hydraulic Fusing / Pressing Machine	- Kannegieser Germany	1 Sets
Front placket fusing machine	- USA	4 Sets
1-Needle lock stitch computerized machine	- Juki Japan	22 Sets
1-Needle heavy duty, needle feed, lock stitch machine	- Juki	15 Sets
1-Needle, needle feed, lock stitch machine computerized-	Juki	13 Sets
1-Needle bottom and variable top feed lock stitch computerized machine	Juki	20 Sets
Automatic 1-Needle, needle feed, lock stitch machine	- Juki	6 Sets
Overlock machine	- Juki Japan	20 Sets
Kansai Special machine	- Union	5 Sets
Flat bed 1-Needle chain stitch machine	- Juki Japan	8 Sets
Flat bed 2-Needle chain stitch machine	- Juki Japan	8 Sets
Feed of the arm chain stitch with upper tape feed	- Juki Japan	6 Sets
Single needle lock stitch machine	- Durkopp	24 Sets
Button stitch Double lock stitch machine	- Durkopp / Juki	12 Sets
Computerized lockstitch button hole machine	- Juki	10 Sets
Engineered Work station (For back yoke)	- Durkopp	8 Sets
Hydraulic die cutting machine	- Italy	1 Sets
Automatic cuff blocking machine	- Weishi	2 Sets
Collar Turning and forming machine	- Weishi	2 Sets
Collar cutting machine	- Weishi	2 Sets
Mark drill machine	- Weishi	4 Sets
Arm hole seam fusing / Pressing machine	- Weishi/Nagashing	8 Sets
Side seam fusing / Pressing machine	- Weishi	8 Sets
Electric steam iron (In line+ Finishing)	- Weishi	40 Sets



PRODUCTION CAPACITY : 120,000 PCS/MONTH

GEVL Chino Pant Unit

(FIFTH FLOOR)



MACHINERIES INFORMATION

Fabric winding & inspection machine
 Auto fabric spread machine
 Band knife cutting machine
 Plain machine
 Double needle machine
 Over lock machine
 Kansal Special Machine
 Heavy Feed Of the Arm
 Eyelet Hole Machine
 Flat Lock Machine
 Bar Tack Machine
 Pocket Welted Machine
 Button Lock stitch Machine
 Snap Button Machine
 Bone pocket welting machine
 Eyelet hole machine
 Mini fusing machine
 Straight liner fusing machine
 Bone pocket press machine
 Flat vacuum iron table machine
 Electric steam iron with silicon rest
 Other machinery and equipment

BRAND

Wishi
 Easeman
 Easeman
 Juki
 Juki
 Juki
 Juki
 Juki
 Durkopp
 Juki
 Durkopp
 Durkopp
 Juki
 UZU

QNTY

1 set
 1 set
 1 set
 201 set
 30 set
 43 set
 05 set
 05 set
 10 set
 02 set
 15 set
 05 set
 05 set
 10 set
 5 set
 5 set
 2 set
 1 set
 5 set
 18 set
 17 set
 43 set



PRODUCTION CAPACITY – 100,000 PCS/MONTH

Kafrul Tower
GREYSTONE SWEATER LTD.
(First Floor)



MACHINERIES INFORMATION

a.	TWIST YARN TRAVENS WINDER 12 SPINDLES	:	8 SETS
b.	HAND DRIVEN FLAT KNITTING MACHINE BED	:	5 GG : 220 SETS
c.	HAND DRIVEN FLAT KNITTING MACHINE BED	:	7 GG : 310 SETS
d.	HAND DRIVEN FLAT KNITTING MACHINE BED	:	12 GG : 720 SETS
f.	AUTOMATIC COLLAR KNITTING MACHINE	:	4 SETS

BRAND NAME OF MACHINERIES : FLYING TIGER & JUKI

NAME OF BUSINESS : 100% EXPORT ORIENTED MANUFACTURER & EXPORTERS.

LEAD TIME : 90 DAYS AFTER L/C



PRODUCTION CAPACITY: 150,000 PCS/MONTH

Kafrul Tower
POWER VANTAGE WEAR LTD
(THIRD FLOOR)



MACHINERIES INFORMATION

QNTY

PLAIN MACHINE (LOCK STITCH)	120 SETS
COMPUTERIZED LOCK STITCH WITH AUTO TIMER MACHINE	14 SETS
OVER LOCK 5 THREAD + 4 THREAD	24 SETS
KANSAI (PSF, PMD)	06 SETS
DOUBLE NEEDLE CHAIN STITCH	06 SETS
AUTOMATIC POCKET WELTED MACHINE	02 SETS
DOUBLE NEEDLE LOCK STITCH	09 SETS
FEED OF THE ARM (2 NEEDLE PULLER)	03 SETS
LOOP MAKING MACHINE	01 SET
DOUBLE NEEDLE ANGULAR MACHINE	04 SETS
UNION SPECIAL 3/5 NEEDLE CYLINDER BED TOP & BOTTOM	03 SETS
UNION SPECIAL 3/5 NEEDLE FLAT BED TOP & BOTTOM	02 SETS
LOCK STITCH POCKET WELTING MACHINE	01 SET
WAIST BAND FUSING MACHINE	01 SET
BLIND STITCH MACHINE FOR HEM	03 SETS
BUTTON HOLE	02 SETS
EYELET BUTTON HOLE (COMPUTERIZED)	02 SETS
BUTTON STITCH (LOCK COMPUTERIZED)	02 SETS
BAR TACKING (COMPUTERIZED)	10 SETS
SNAP ATTACHING MACHINE AUTO	06 SETS
CUTTING MACHINE	03 SETS
BAND KNIFE MACHINE	01 SET
DICE CUTTING MACHINE	01 SET
END CUTTER MACHINE	01 SET
FABRICS INSPECTION MACHINE	01 SET
THREAD SUCKER	01 SET
SPOT REMOVER WITH COMPRESSOR	03 SETS
NEEDLE DETECTOR	01 SET
STEAM BOILER 100 KGS	01 SET
ELECTRIC CONTROL AUTO STEAM	08 SETS
VACUUM IRON TABLE	08 SETS
AUTOMATIC LEGER PRESS	03 SETS
AUTOMATIC TROOPER PRESS	05 SETS
AUTOMATIC STRAPPING MACHINE	01 SET



GENERATOR	: STAND BY WILSON GENERATOR 350 KVA
TRANSFORMER	: 315 KV
BRAND NAME OF MACHINERIES	: JUKI, NAGI SHING & REECE.

PRODUCTION CAPACITY: 60,000 PCS/MONTH

Kafrul Tower
SHIRTS MINE LTD.
(FIFTH FLOOR)

MACHINERIES INFORMATION

	<u>QNTY</u>
PLAIN MACHINE (LOCK STITCH)	86 SETS
PLAIN MACHINE WITH PULLER	06 SETS
COMPUTERIZED LOCK STITCH WITH AUTO TIMER	30 SETS
LOCK STITCH WITH NEEDLE FEED	05 SETS
LOCK STITCH WITH VERTICAL TRNEMER/KNIFE	03 SETS
KANSAI (PMD)	06 SETS
SINGLE NEEDLE CHAIN STITCH	08 SETS
DOUBLE NEEDLE CHAIN STITCH	08 SETS
FEED OF THE ARM (2 NEEDLE)	10 SET
BUTTON HOLE	09 SETS
BUTTON STITCH (LOCKSTITCH COMPUTERIZED)	12 SETS
FUSING	01 SET
COLLAR TURNING	02 SETS
COLLAR CREASING	01 SET
COLLAR BOTTOM CUTTING	01 SET
POCKET CREASING	02 SETS
CUFF CREASING	02 SETS
FRONT PLACKET FUSING	01 SET
SLEEVE PLACKET CREASING /FUSING	01 SET
ARMHOLE PRESSING MACHINE	03 SETS
BAND KNIFE MACHINE	01 SET
DICE CUTTING MACHINE	03 SETS
CUTTING MACHINE	02 SETS
END CUTTER MACHINE	01 SET
FABRICS INSPECTION MACHINE	01 SET
SPOT REMOVER WITH COMPRESSOR	03 SETS
THREAD SUCKER	01 SET
STEAM BOILER 100 KGS	01 SET
VACUUM IRON TABLE	09 SETS
ELECTRIC CONTROL AUTO STEAM	06 SETS
FOLDING TABLE	09 SETS
NEEDLE DETECTOR	01 SET
AUTOMATIC STRAPPING MACHINE	01 SET
OVER LOCK	17 SETS
BARTECH	02 SETS
IRON	02 PCS



GENERATOR : STAND BY WILSON GENERATOR 350 KVA
 TRANSFORM : 315 KV
 BRAND NAME OF MACHINERIES : JUKI, NAGI SHING & REECE.



PRODUCTION CAPACITY: 120,000 PCS / MONTH

TECHNICAL AND PREPARATORY UNIT

SAMPLE SECTION
(7th FLOOR)



C.A.D SECTION
(7th FLOOR)

LABORATORY
(2nd FLOOR)



Compliance & Good Management Practices

Compliance Management System

“Effective implementation and monitoring the principles of management throughout the organization with compliant of the national & international law / legislation and standard to improve relation between employees and management”

Objectives:

- ❑ Meeting compliance with the country law & customers' "Code of Conduct (CoC)".
- ❑ To compliance with social responsibility.
- ❑ Maintaining high standard of health, safety and environment.
- ❑ Knowing and meeting the applicable statutory and regulatory requirements.
- ❑ Providing necessary resources including knowledge and training to employees.



Focus of the Compliance Management System:

Employment Policy:

- ❑ Child Labour: Children are strictly prohibited to be employed.
- ❑ Equal Treatment / No Discrimination: All employees have equal access to jobs.
- ❑ Compensation: Wages paid as per legally mandated minimum rates.
- ❑ Working Hours: working hours followed with the prevailing laws.
- ❑ Leave: Employees are entitled as per legally mandated leave.
- ❑ No Harassment or Abuse: Work environment free of harassment or abuse.
- ❑ Voluntary Employment: Forced labour, involuntary prison labour is not allowed.
- ❑ All workers are oriented before going to the workstation.



Workplace Environment of factory:

- ❑ Floors are designed and allocated as per international compliance standard.
- ❑ Equipment and machineries are allocated with compliant.
- ❑ Space for employees is maintained as per standard in the floor.
- ❑ Work stations are properly ventilated.
- ❑ Floors are maintained neat and clean.
- ❑ Separate store for fabrics and accessories.
- ❑ All goods in the stores are properly labeled. Bin cards available.



Health & Safety:

- ❑ Assured a safe and hygienic working environment.
- ❑ Appropriate and adequate personal safety equipment and clothing are provided.
- ❑ Employees are provided potable drinking water, hygiene toilets, & washing facilities.
- ❑ All electric appliances are maintained by qualified engineers and electricians.
- ❑ Noise and lights are maintained as per standard.
- ❑ Only trained and designated persons are handled chemicals and heavy materials.
- ❑ Available safety instructions and MSDS are provided near to the work station.
- ❑ Awareness programs are conducted with the employees periodically to aware H & S.
- ❑ Sufficient first-aid boxes are provided in the work station.
- ❑ A well equipped medical centre is provided with full time doctor and nurses.



Compliance & Good Management Practices



Fire Safety:

- ❑ Sufficient Fire extinguishers, automatic fire hydrant and other eqpt are installed.
- ❑ Workers are trained and wear identification badge.
- ❑ Aisles, exits and stairs are maintained free of obstructions and marked permanently by using color tiles.
- ❑ Electronic fire alarm system in placed. Smoke detector, public addressed (PA) system and Emergency lights are installed.
- ❑ Every floor has separate evacuation plan.
- ❑ All employees are insured by a group insurance policy.

Security:

- ❑ Company has won trained sufficient security guards for all factories.
- ❑ A written security policy has been established as per requirement of C-TPAT.
- ❑ All premises are secured by the Close Circuit TV Camera (CCTV Camera).
- ❑ Appropriate measures takes, such as secure premises to prevent entry,
- ❑ restricted access to the production facility by non-employees, authorized ID-cards and escorting of visitors while in the facility etc.



Workers Welfare:

- ❑ Workers welfare committee formed in the factory.
- ❑ Welfare officer communicates with the committee.
- ❑ Committee meeting held in every month.
- ❑ Separate dining room for male and female.
- ❑ Separate pray/ religious room.
- ❑ Childcare room having trained babysitter.

Environmental Protection:

- ❑ All factories of the group are compliant with national environmental legislation.
- ❑ A 250 M3 Effluent Treatment Plant (ETP) has been established in the factory to treat the effluent of the factory.
- ❑ A written policy has been introduced to manage and dispose the wastage.



TOTAL EMPLOYEE OF AMTRANET GROUP

UNIT/DIVISION	STAFF
H.O,HRD,COMPLIANCE & ADMINISTRATION	253
SECURITY PERSONNEL	120
PRODUCTION STAFF	317
WORKER(MALE & FEMALE)	3681
TOTAL	4371

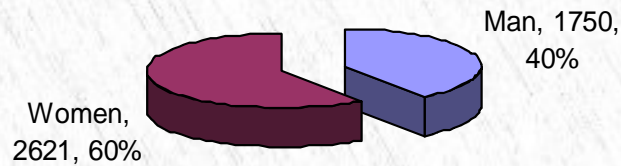
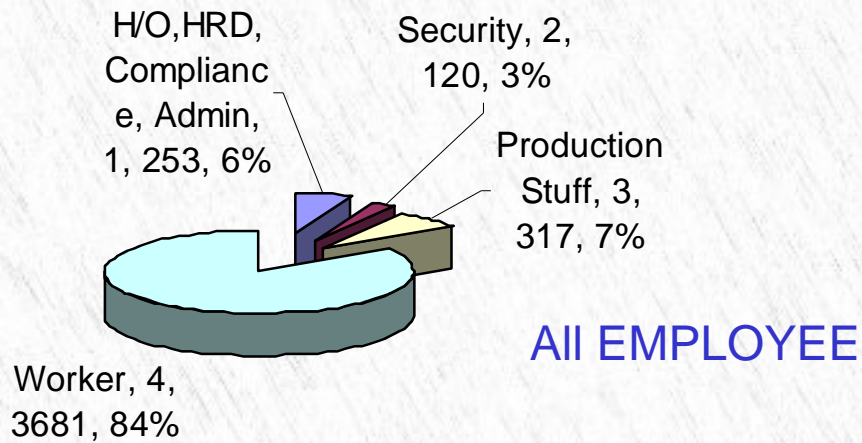

WORKER (MALE & FEMALE)

Share of Production

In Terms of Qty & Value, 2006

Buyer	Qty in pcs	Value in Million
Haggar	1389529	US\$ 6.86
Carrefour	619317	US\$ 1.98
Manifattura Corona SPA	353359	US\$ 2.32
Auchan	342787	US\$ 1.544
Dorsey	286313	US\$ 0.953
Grouppocoin	280111	US\$ 1.745
Quelle+Neckermann	266213	US\$ 1.197
Kiabi	180761	US\$ 0.737
Tessival	102174	US\$ 0.27
Other Buyers	343616	US\$ 1.557
Total	4164180	US\$ 19.163

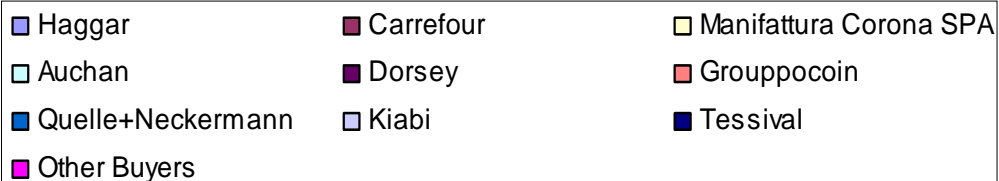
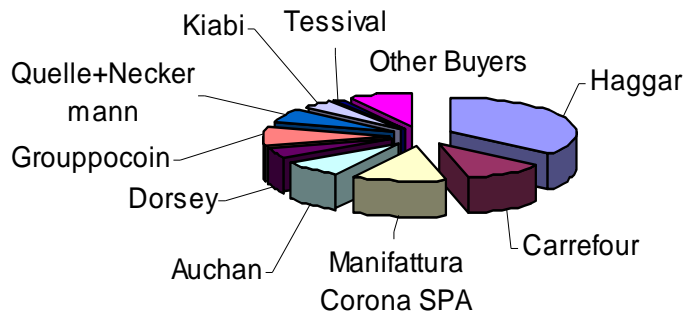

Share of Production

In Terms of Qty & Value, 2007

Buyer	Qty in pcs	Value in Million
Haggar	1036832	US\$ 5.35
Kiabi	392175	US\$ 1.57
Corona	384433	US\$ 2.44
G. Coin	250556	US\$ 1.75
H&M	245651	US\$ 1.91
Dorsey	220107	US\$ 0.71
Auchan	217146	US\$ 1.19
Carrefour	215891	US\$ 0.86
Renner	161340	US\$ 0.63
Pull & Bear	118833	US\$ 0.72
Kiazn	83357	US\$ 0.57
Scidenstiker	38331	US\$ 0.24
Other Buyers	1098765	US\$ 3.89
Total	4463417	US\$21.83

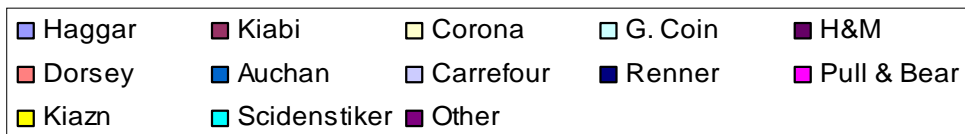
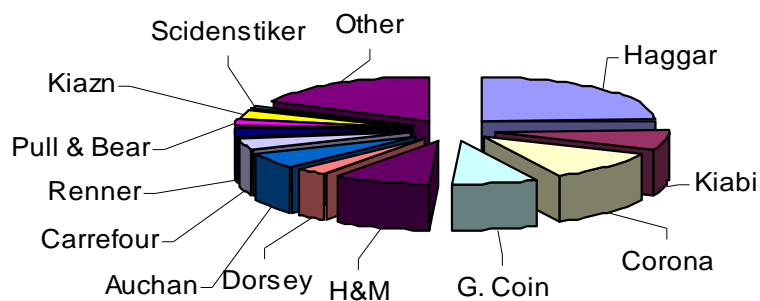



THANK YOU